

SPLIT NUT
PART # TC7419HPM20

PART # TC7419MP12P

M20
INSTRUMENT
CONNECTION

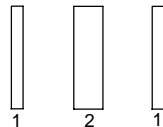
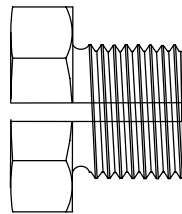

SPRING

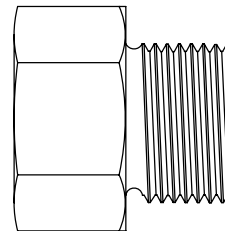

1/2" BSPP PARALLEL
PROCESS
CONNECTION

SLOTTED 316 S/S
DISC

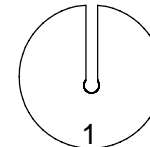

SLOTTED RUBBER
DISC

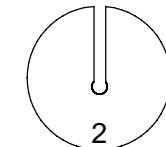

COMPRESSION FITTING ASSEMBLY SPRING LOADED ON CAPILLARY

TEMPERATURE CONTROLS PTY LTD

Certificate No: QEC 14412
AS/NZS 9001:2000

CONDITIONS

THIS DRAWING IS OUR EXCLUSIVE PROPERTY AND MUST NOT BE COPIED OR HANDED TO ANY OTHER PARTIES WITH OUT WRITTEN PERMISSION. IT SHALL BE RETURNED UPON REQUEST

SYDNEY : 7 YAMMA ST SEFTON , NSW 2162
PHONE : (02) 9721 8644 FAX : (02) 9738 9339
MELBOURNE : 8/280 Whitehall St
YARRAVILLE VIC 3013
PHONE : (03) 9687 0000 FAX : (03) 9687 1900
EMAIL : sales@temperature.com.au



TITLE

SIZE : A4

DATE : 05/09/12

DWG NO : SD 6000

SCALE : NTS

DRAWING BY R.B

REV : 00